



SPECIFICATION SHEET

CAT5E UTP FEMALE TO FEMALE COUPLER

ITEM NO.: UMPM7001



KEY FEATURES :

- High Quality CAT5E UTP Female to Female Coupler
- The screw design helps to connect the device tightly
- Convenient way to combine two Patch cables through a panel without any signal loss
- Meets or exceeds TIA/EIA -568-C.2 and ISO/IEC 11801 Specification
- Provides outstanding transmission performance and low signal loss
- Tested to 350 MHz and support 1000 Base-T Gigabit Ethernet
- Lifetime Warranty

CAT5E UTP FEMALE TO FEMALE COUPLER

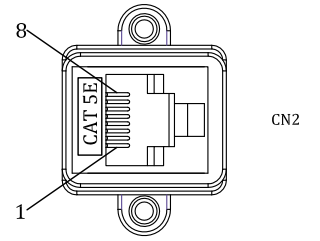
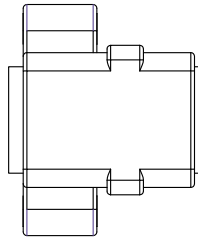
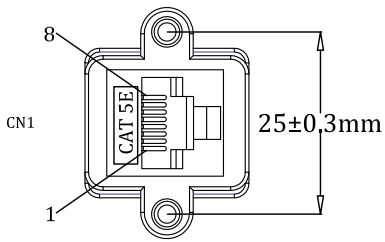
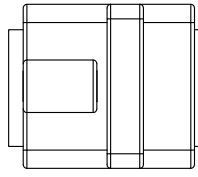

Diagram

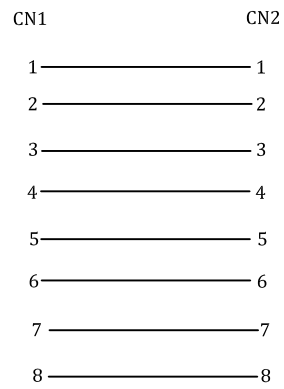

CAT5E UTP FEMALE TO FEMALE COUPLER

Electrical Characteristics:

Conductor DC Resistance:	89 Ohm/km (maximum)
Insulation Resistance :	100 Ohm/km (minimum)
Dielectric Strength:	500 MV/m
Propagation Delay:	545ns/100m (maximum)
Delay Skew:	45ns/100m (maximum)

Physical Characteristics:

Voltage Rating:	30V
Temperature Rating:	80°C
Operating Temperature R-	-20 °C - 80 °C
Storage Temperature Rar-	-25 °C - 85 °C
Approvals:	RoHS, CE, UL Compliant

Customized Parameters

Color:	Black or Customized
Package type:	PE bag, Zip bag, Box, Hang card, Blist